

## Ground Joint Air Hammer Couplings with Female Spud

### Female Spuds

#### Features

- Rounded steel head of stem fits concave inserts in spuds for superior sealing
- Metal-to-metal copper seat seal
- For use with Boss clamps on pages 169-170

Style	Hose Shank x NPT	Plated Steel/Iron Part #
Compact	1/2"	GDF6
	3/4"	GDF8
Heavy duty	3/4"	GDF10
	1"	GDF12

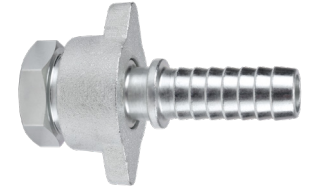

D

### Stems

Style	Size	Plated Steel Part #
Compact	1/2"	GBA45
	3/4"	GBA46
Heavy duty	3/4"	GBB18
	1"	GBB11



### Wing Nuts

Style	Size	Coarse Nut Thread	Iron Part #
Compact	1/2"	1-31/64" O.D. x 8 TPI	J47
	3/4"		J47
Heavy duty	3/4"	1-47/64" O.D. x 8 TPI	DLB12
	1"		DLB12



### Female Spuds

Style	Size	Coarse Nut Thread	Plated Steel w/Copper seat Part #
Compact	1/2"	1-31/64" O.D. x 8 TPI	GJ65
	3/4"		GJ55
Heavy duty	3/4"	1-47/64" O.D. x 8 TPI	GDL8
	1"		GDL13



### Male Spuds

Style	Size	Coarse Nut Thread	Plated Steel w/Copper seat Part #
Compact	1/2"	1-31/64" O.D. x 8 TPI	GJ60
	3/4"		GJ50
Heavy duty	3/4"	1-47/64" O.D. x 8 TPI	GDL7
	1"		GDL10



### Double Spuds

Style	Size	Coarse Nut Thread	Plated Steel w/Copper seat Part #
Compact	1/2"	1-31/64" O.D. x 8 TPI	GJ75
	3/4"		GJ75
Heavy duty	3/4"	1-47/64" O.D. x 8 TPI	GDL25
	1"		GDL25

