



Clapper Type Snoots – Pin Lug

Features

- Other sizes and threads are available, consult Dixon® for information
- Finishes: -P polished, -C polished chrome plated

Approval

- UL listed

Specification

- Working pressure: **300 PSI**

Outlet Female NPT Thread	Inlet Female NST (NH) Thread	Cast Brass Part #
3"	2-1/2"	CSCTF25F30T-P
		CSCTF25F30T-C

Outlet Male NPT	Inlet Female NST (NH)	Cast Brass Part #
3"	2-1/2"	CSCTM25F30T-P
		CSCTM25F30T-C



polished, chrome plated



polished

Wall Plate for Double Clapper Siamese Assemblies

Features

- 4-hole and 6-hole wall plates available, • Finishes: -P polished, -C polished chrome plated consult Dixon for information

Hole Size	Branding	Brass Part #
3-3/8"	AutoSprinkler	WP2HH-AS-P611
		WP2HH-AS-C611
	StandPipe	WP2HH-SP-P611
		WP2HH-SP-C611
	AutoSprinkler StandPipe Combo	WP2HH-ASSP-P610
		WP2HH-ASSP-C611
	Hydrant	WP2HH-HYD-P611
	PumpTest	WP2HH-PTC-P611
		WP2HH-PTC-C611



Dimensions

Hole Size	A	B	C	D
3-3/8"	14"	8"	7-5/8"	4-15/16"

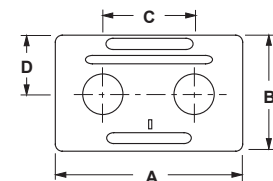

Wall Plate for Concealed 3-Way Bodies

Features

- 4-hole and 6-hole wall plates available, • Finishes: -P polished, -C polished chrome plated consult Dixon for information

Hole Size	Positioned	Branding	Brass Part #
3-5/8"	Horizontal	AutoSprinkler	WP3HH-AS-P231
			WP3HH-AS-C231
		StandPipe	WP3HH-SP-P231
			WP3HH-SP-C231



Dimensions

