

Bevel Seat Ferrules

Recessed Threaded Bevel Seat Ferrules – 15

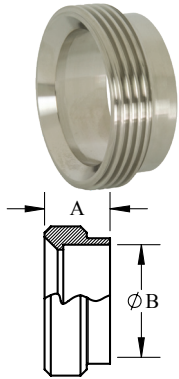

Tube O.D.	A (in)	B (in)	304 Stainless Steel Part #
1"	.81	1.01	15-G100
1-1/2"	.88	1.51	15-G150
2"	1.03	2.01	15-G200
2-1/2"	1.13	2.51	15-G250
3"	1.25	3.01	15-G300
4"	1.38	4.01	15-G400

Recessless Threaded Bevel Seat Ferrules for Expanding – 15R

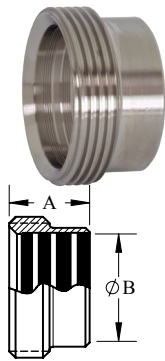

Tube O.D.	A (in)	B (in)	304 Stainless Steel Part #
1"	.81	1.01	15R-G100
1-1/2"	1.13	1.51	15R-G150
2"	1.38	2.01	15R-G200
2-1/2"	1.50	2.51	15R-G250
3"	1.63	3.01	15R-G300
4"	1.68	4.01	15R-G400

M

621
3
63-04

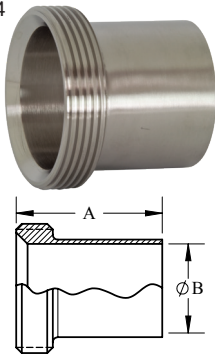

Light Wall Tank Threaded Bevel Seat Ferrules – 15WL

Tube O.D.	A (in)	B (in)	Nominal Wall (in)	304 Stainless Steel Part #
1"	2.00	.87	.065	15WL-G100
1-1/2"	2.25	1.37		15WL-G150
2"	2.50	1.87		15WL-G200
2-1/2"	2.75	2.37		15WL-G250
3"	3.00	2.87	.083	15WL-G300
4"	4.00	3.83		15WL-G400

621
3
63-04

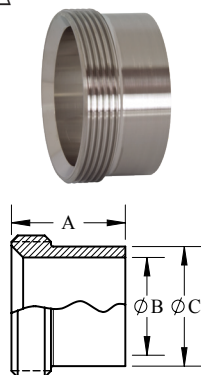

Heavy Wall Tank Threaded Bevel Seat Ferrules – 15W

Size	A (in)	B (in)	C (in)	304 Stainless Steel Part #	316L Stainless Steel Part #
1"	1.50	.87	1.16	15W-G100	15W-R100
1-1/2"	1.63	1.37	1.68	15W-G150	15W-R150
2"	1.75	1.87	2.19	15W-G200	15W-R200
2-1/2"	1.75	2.37	2.71	15W-G250	15W-R250
3"	1.81	2.87	3.22	15W-G300	15W-R300
4"	2.13	3.83	4.26	15W-G400	15W-R400