

**Hydraulic Adapters – NPTF**

**Male Hex Pipe Nipples**

**Specifications**

- Reference SAE 140137
- Pressure rating at 70°F (21°C)



Male NPTF	Male NPTF	PSI	Zinc Plated Steel Part #
1/8" – 27	1/8" – 27	5000	5404-2
1/4" – 18	1/4" – 18		5404-4
3/8" – 18	3/8" – 18	4000	5404-6
	1/4" – 18		5404-6-4
1/2" – 14	1/2" – 14	3000	5404-8
	3/8" – 18		5404-8-6
3/4" – 14	3/4" – 14	2500	5404-12
	1/2" – 14		5404-12-8
1" – 11-1/2	1" – 11-1/2	2000	5404-16
	3/4" – 14		5404-16-12
1-1/4" – 11-1/2	1-1/4" – 11-1/2	1150	5404-20

**Male x Female Hex Reducer Bushings**

**Specifications**

- Reference SAE 140140
- Pressure rating at 70°F (21°C)

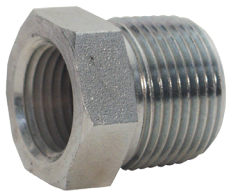

Male NPTF	Female NPTF	PSI	Zinc Plated Steel Part #
1/4" – 18	1/8" – 27	5000	5406-4-2
3/8" – 18	1/8" – 27	4000	5406-6-2
	1/4" – 18		5406-6-4
1/2" – 14	1/8" – 27	3000	5406-8-2
	1/4" – 18		5406-8-4
	3/8" – 18		5406-8-6
3/4" – 14	1/8" – 27	2500	5406-12-2
	1/4" – 18		5406-12-4
	3/8" – 18		5406-12-6
	1/2" – 14		5406-12-8
1" – 11-1/2	1/4" – 18	2000	5406-16-4
	3/8" – 18		5406-16-6
	1/2" – 14		5406-16-8
	3/4" – 14		5406-16-12
1-1/4" – 11-1/2	3/8" – 18	1150	5406-20-6
	1/2" – 14		5406-20-8
	3/4" – 14		5406-20-12
	1" – 11-1/2		5406-20-16
1-1/2" – 11-1/2	1/2" – 14	1000	5406-24-8
	3/4" – 14		5406-24-12
	1" – 11-1/2		5406-24-16
	1-1/4" – 11-1/2		5406-24-20
2" – 11-1/2	1/2" – 14	1000	5406-32-8
	3/4" – 14		5406-32-12
	1" – 11-1/2		5406-32-16
	1-1/4" – 11-1/2		5406-32-20
	1-1/2" – 11-1/2		5406-32-24

K

**90° Male x Male Elbows**

**Specifications**

- Reference SAE 140237
- Pressure rating at 70°F (21°C)



Male NPTF	Male NPTF	PSI	Zinc Plated Steel Part #
1/4" – 18	1/4" – 18	5000	5500-4
3/8" – 18	3/8" – 18	4000	5500-6
1/2" – 14	1/2" – 14	3000	5500-8
3/4" – 14	3/4" – 14	2500	5500-12
1" – 11-1/2	1" – 11-1/2	2000	5500-16